

BRISTOL DISTRICT DESIGN UNIT

PROJECT MANAGER James Bullins 276-696-3349
SURVEYED BY, DATE Woody McCowan 276-525-6483, June 2018
DESIGN BY James Bullins 276-696-3349
SUBSURFACE UTILITY BY, DATE J.A.

Utility Owners
Fiber Optic Lines Property of Scott Co. Telephone
Power Lines Property of Old Dominion
Sewer Lines Property of Town of Big Stone Gap
Telephone Lines Property of Verizon
Water Lines Property of Town of Big Stone Gap

REVISED	STATE	ROUTE	STATE		SHEET NO.
			PROJECT		
	VA.	58	0058-101-902, RW-201		3
DESIGN FEATURES RELATING TO CONSTRUCTION OR TO REGULATION AND CONTROL OF TRAFFIC MAY BE SUBJECT TO CHANGE AS DEEMED NECESSARY BY THE DEPARTMENT					
VDOT Location & Design Bristol, Virginia HYDRAULIC ENGINEER			VDOT Location & Design Bristol, Virginia ROADWAY ENGINEER		

GILLEY AVENUE
US 58 ALT./ US 23 BUS.

ADDITIONAL EASEMENTS FOR UTILITY RELOCATIONS MAY BE REQUIRED BEYOND THE PROPOSED RIGHT-OF-WAY SHOWN ON THESE PLANS.

RANDY LOVELL
INST# 201200058
(Deed) Tract 1 2.735 AC./-
(Deed) Tract 9 0.484 AC./-
TAX MAP# 076A5 (03) 001D 001L

END PROJECT 0058-101-902, C-501
BEGIN TRANSITION
STATION 112+54.63

VELMA K. GILLEY
INST# W09000087
INST# W09000087
(NINTH) Tract 8 0.513 AC./-
TAX MAP# 076A5 (03) 001K

HEIRS OF PALMER LOVELL
INST# W08000087
INST# W08000087
(Plat) Tract 1 0.432 AC./-
TAX MAP# 076A5 (03) 001J

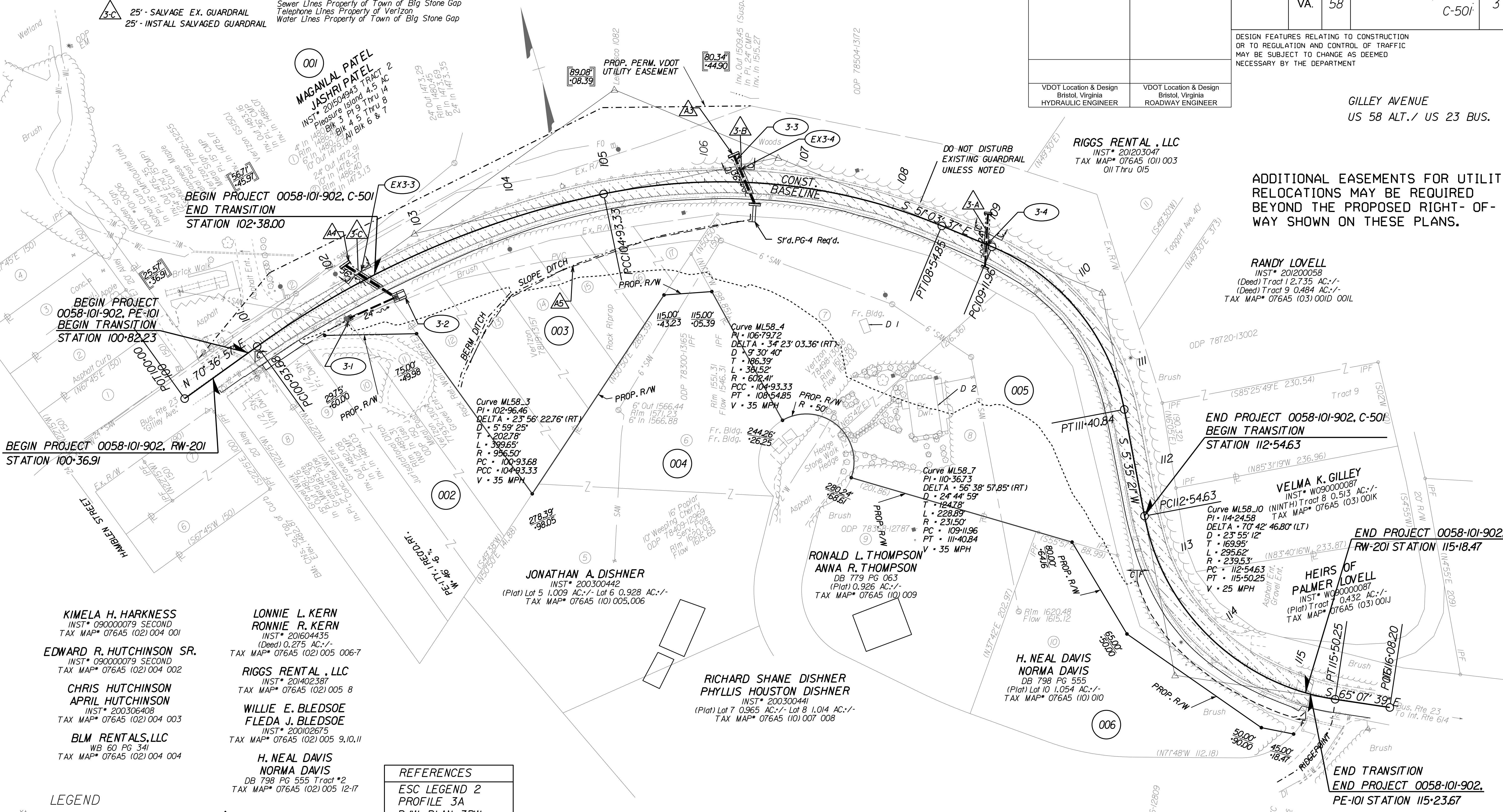

KIMELA H. HARKNESS
INST# 090000079 SECOND
TAX MAP# 076A5 (02) 004 001

EDWARD R. HUTCHINSON SR.
INST# 090000079 SECOND
TAX MAP# 076A5 (02) 004 002

CHRIS HUTCHINSON
INST# 200306408
TAX MAP# 076A5 (02) 004 003

BLM RENTALS, LLC
WB 60 PG 341
TAX MAP# 076A5 (02) 004 004

LONNIE L. KERN
RONNIE R. KERN
INST# 201604435
(Deed) 0.275 AC./-
TAX MAP# 076A5 (02) 005 006-7

RIGGS RENTAL, LLC
INST# 201402387
TAX MAP# 076A5 (02) 005 8

WILLIE E. BLEDSOE
FLEDA J. BLEDSOE
INST# 200102675
TAX MAP# 076A5 (02) 005 9,10,11

H. NEAL DAVIS
NORMA DAVIS
DB 798 PG 555 Tract #2
TAX MAP# 076A5 (02) 005 12-17

JONATHAN A. DISHNER
INST# 200300442
(Plat) Lot 5 1.009 AC./- Lot 6 0.928 AC./-
TAX MAP# 076A5 (10) 005,006

RONALD L. THOMPSON
ANNA R. THOMPSON
DB 779 PG 063
(Plat) 0.926 AC./-
TAX MAP# 076A5 (10) 009

RICHARD SHANE DISHNER
PHYLLIS HOUSTON DISHNER
INST# 200300441
(Plat) Lot 7 0.965 AC./- Lot 8 1.014 AC./-
TAX MAP# 076A5 (10) 007 008

H. NEAL DAVIS
NORMA DAVIS
DB 798 PG 555
(Plat) Lot 10 1.054 AC./-
TAX MAP# 076A5 (10) 010

LEGEND

- Denotes Demolition of Pavement
- Denotes Drainage Information
- Denotes Construction Limits In Cuts
- Denotes Construction Limits In Fills
- Denotes Paved Shoulder & Paving Over Pipes
- Denotes Planting of Pavement
- WL-- Wet Land Area

UTILITY LEGEND

- Utility Poles & Guy Wire
- Water Meter
- Sewer Line & MH
- Water Line
- Underground Fiber Optic Line
- Telephone Junction Box

REFERENCES

ESC LEGEND 2
PROFILE 3A
R/W PLAN 3RW
ENTR. PROFILE 4

NOTE:

- 1) R/W Based on Construction Baseline Unless Otherwise Noted
- 2) Figures in double brackets and dot - dashed lines denotes Permanent Utility Easements.

- NOT USED
- NOT USED
- EXISTING 24" CMP TO BE REMOVED.
- EXISTING 36" PIPE TO BE REMOVED
- OFFSITE CONVEYANCE CHANNEL REFERENCE ROADWAY CROSS SECTIONS

PUBLIC HEARING PLANS

THESE PLANS ARE UNFINISHED AND UNAPPROVED AND ARE NOT TO BE USED FOR ANY TYPE OF CONSTRUCTION OR THE ACQUISITION OF RIGHT OF WAY.

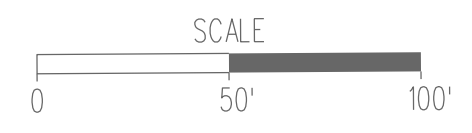

PROJECT	0058-101-902	SHEET NO.	3
---------	--------------	-----------	---